



Road Management Services

Working on behalf of



0300 123 5000

www.nationalhighways.co.uk

16th January 2026

Major Maintenance on A419/A417

We are planning essential maintenance at the A419/A417. The work will affect various sections of the A419/A417. Please note that the remaining sections of the A419/A417 outside of the works area shall operate as usual.

What work is being carried out?

The work being delivered is crack sealing of the carriageway on various sections of the A419/A417.

What are the benefits to road users?

The crack sealing is required as it prevents significant damage of the carriageway which would require more disruptive repairs in the future. This overall reduces interventions, so the road remains open thus reducing delays and improving journey time reliability. Also, it will provide a safer and smoother journey for road users.

When and where will the work be carried out? (Traffic restrictions – check before you travel)

There are night closures closure scheduled on the A419/A417 network.

- **Overnight closure** from 20:00 hours until 06:00 hours the following morning
- **A417 Closure between Burford Road Interchange and Quarry Junction (Diversion Route 5 Northbound)**
 - Overnight closures ONLY on Tuesday 27th January and Wednesday 28th January

- **A417 Closure between Quarry Junction and Burford Road Interchange (Diversion Route 5 Southbound)**
 - Overnight closures ONLY on Thursday 29th January and Friday 30th January
 - Overnight closure ONLY on Monday 2nd February
- **A419 Closure between Burford Road Interchange and Spine Road Junction (Diversion Route 6 Southbound)**
 - Overnight closures ONLY on Tuesday 3rd February and Wednesday 4th February
- **A419 Closure between Spine Road Junction and Cricklade Junction (Diversion Route 7 Southbound)**
 - Overnight closure ONLY on Thursday 5th February
- **A419 Closure between Cricklade Junction and Spine Road Junction (Diversion Route 7 Northbound)**
 - Overnight closures ONLY on Friday 6th February and Saturday 7th February
- **A419 Closure between Spine Road Junction and Burford Road Interchange (Diversion Route 6 Northbound)**
 - Overnight closures ONLY on Sunday 8th February to Tuesday 10th February

The A419/A417 will be fully operational as usual outside of the specified hours. Diversion routes will be signed, and signage will also be in place before the start of works as a reminder.

Property access

Should access to your property be required, traffic management personnel will make every effort to facilitate this. However, some delay may occur while safety measures are implemented to allow safe passage through the work site. A contact number will be provided at the closure entrance for assistance.

Diversion route

The proposed diversion routes for the closures are outlined below. Please refrain from following satellite navigation systems and instead adhere to the signed diversion routes, which correspond to the diversion maps enclosed with this letter and are clearly marked with diversion symbols at the start of the diversion routes (e.g. for Diversion Route 5 Northbound, follow ).

Diversion Route 5 Northbound – A417 Closure between Burford Road and Quarry Interchange

From the A417 Northbound Carriageway take the Burford Road Interchange exit slip road and take the 1st exit at the roundabout signed Cirencester A429, Stroud A419, Stratton.

At the next roundabout take 3rd exit signed Gloucester A417, Cheltenham (A435).

Continue on the A435 to split then straight on signed Daglingworth / Birdlip (Follow old A417 NOT A435) to the roundabout at the A417 Quarry Interchange.

Take the 2nd exit signed M5, Gloucester A417.

Diversion Route 5 Southbound – A417 Closure between Quarry Interchange and Burford Road Interchange

From the A417 Southbound Carriageway take the Quarry Interchange exit slip road and then take the 3rd exit at the roundabout signed Stratton.

Continue under A417 to the 2nd roundabout and take the 1st exit signed Stratton.

At Cirencester roundabout take the 1st exit signed Stow A429, Burford (B4425), Lechlade (A417).

At Burford Road Interchange roundabout take the 2nd exit over the A417 signed M4, Swindon A419.

At the next roundabout take the 3rd exit signed M4, Swindon A419.

Diversion Route 6 Northbound – A419 Closure between Spine Road Junction and Burford Road Interchange

From the A419 Northbound Carriageway take the Spine Road Junction exit slip road and then take the 2nd exit at the roundabout signed Cirencester, Stroud A419.

At 2nd roundabout take the 1st exit continuing on the A419 Northbound.

At 3rd roundabout take the 2nd exit signed Cirencester A419.

At 4th roundabout take the 3rd exit Cirencester A419, Cheltenham (A435), Motorway (M5), Gloucester (A417), Stow (A429).

At 5th roundabout take the 3rd exit signed Stow A429, Burford (B4425), Lechlade (A417).

At 6th roundabout take the 1st exit signed (M5), Gloucester A417 onto entry slip road to A417 Northbound Carriageway.

Diversion Route 6 Southbound – A419 Closure between Burford Road Interchange and Spine Road Junction

From the A417 Southbound Carriageway take the Burford Road Interchange exit slip and take the 4th exit at the roundabout over the A417 Carriageway signed Cirencester A429, Stroud (A419).

At 2nd roundabout take the 1st exit signed Cirencester A429, Stroud (A419).

At 3rd roundabout take 1st exit signed The South West, Stroud, Swindon A419, Chippenham (A429).

At 4th roundabout take the 1st exit signed Swindon A419.

At 5th roundabout take the 1st exit signed Swindon A419.

At 6th roundabout take 2nd exit signed (M4), Swindon A419.

At 7th roundabout, South Cerney Junction, take 1st exit and continue over the A419 Carriageway.

At 8th roundabout take 3rd exit onto A419 Southbound entry slip road.

Diversion Route 7 Northbound – A419 Closure between Cricklade Junction and Spine Road Junction

From the Cricklade Northbound exit slip road take the 2nd exit at the Cricklade roundabout signed Cricklade B4040.

At 1st roundabout take 1st exit signed Malmesbury B4040.

At 2nd roundabout take 1st exit onto the High Street signed Malmesbury B4040.

At 3rd roundabout take 2nd exit signed Malmesbury B4040.

At Common Hill Roundabout take 1st exit onto Malmesbury Road signed Malmesbury B4040.

At crossroad take turn right onto Ashton Road signed Ashton Keynes B4696.

At crossroad take turn right onto Spine Road East signed Swindon B4696.

At South Cerney roundabout take 4th exit signed Swindon A419.

Diversion Route 7 Southbound – A419 Closure between Spine Road Junction and Cricklade Junction

From the South Cerney Southbound exit slip road take the 4th exit at the 1st South Cerney roundabout signed Ashton Keynes B4696.

At 2nd South Cerney roundabout take 2nd exit onto the Spine Road East signed Ashton Keynes B4696.

At the T-junction turn left on to Ashton Road signed Wooton Bassett B4696.

At the junction turn right signed Wooton Bassett B4696.

At the crossroads turn left onto Malmesbury Road signed Leigh B4040.

At Common Hill roundabout take the second exit signed Town centre.

At 1st roundabout take 1st exit onto the High Street signed Cirencester A419.

At 2nd roundabout take 2nd exit signed Cirencester A419.

At 3rd roundabout take 2nd exit signed through traffic.

At Cricklade roundabout take 2nd exit onto Swindon Road signed Swindon A419.

Contact

Fatima Alawad (Stakeholder Support Manager)

Email: Fatima.Alawad@wsp.com

Yours sincerely,

A handwritten signature in black ink, appearing to read 'Mike Jackson', is displayed on a light yellow rectangular background.

Mike Jackson
Road Manager

Enc. Diversion Route Map

ROUTE 5

**A417 Northbound Closed
Between
Burford Road Interchange
And
Quarry Interchange**



A417 NORTHBOUND CLOSED BETWEEN BURFORD ROAD INTERCHANGE AND QUARRY INTERCHANGE

Diversion Route
Symbol



Action Points
Step 1: Close A417 Northbound carriageway at Burford road Interchange.
Step 2: Open trigger signs at Burford road Interchange Exit Slip road..
Reverse procedure at end of closure.

A417 Northbound Main Carriageway at Burford Road Northbound Exit Slip Road.

Standard Road Closure to TMC requirements

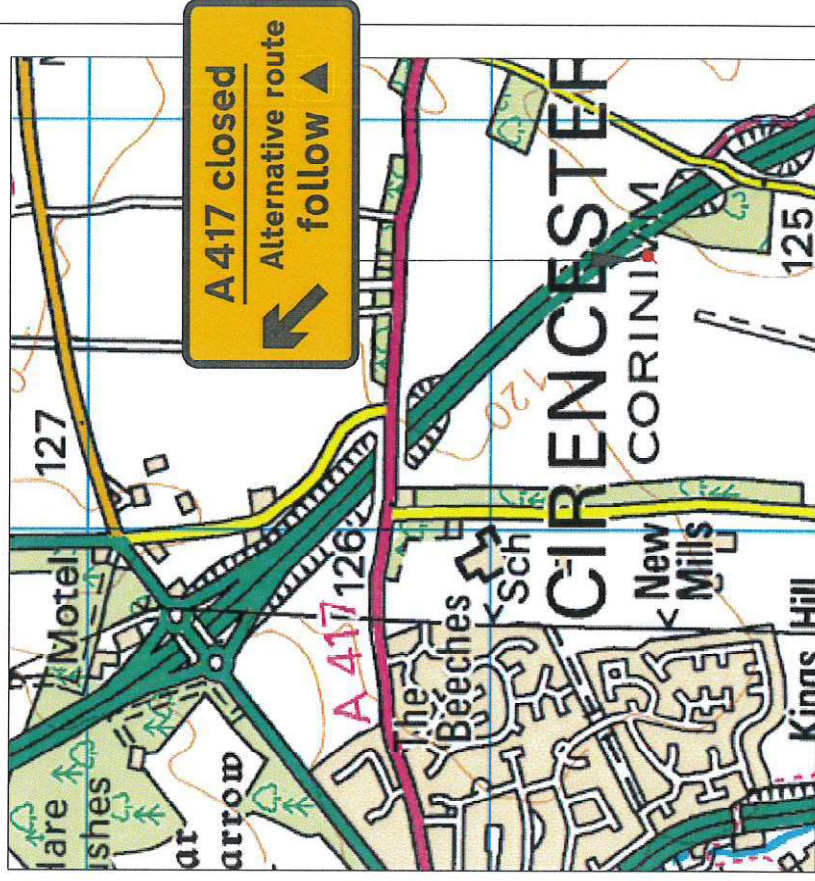
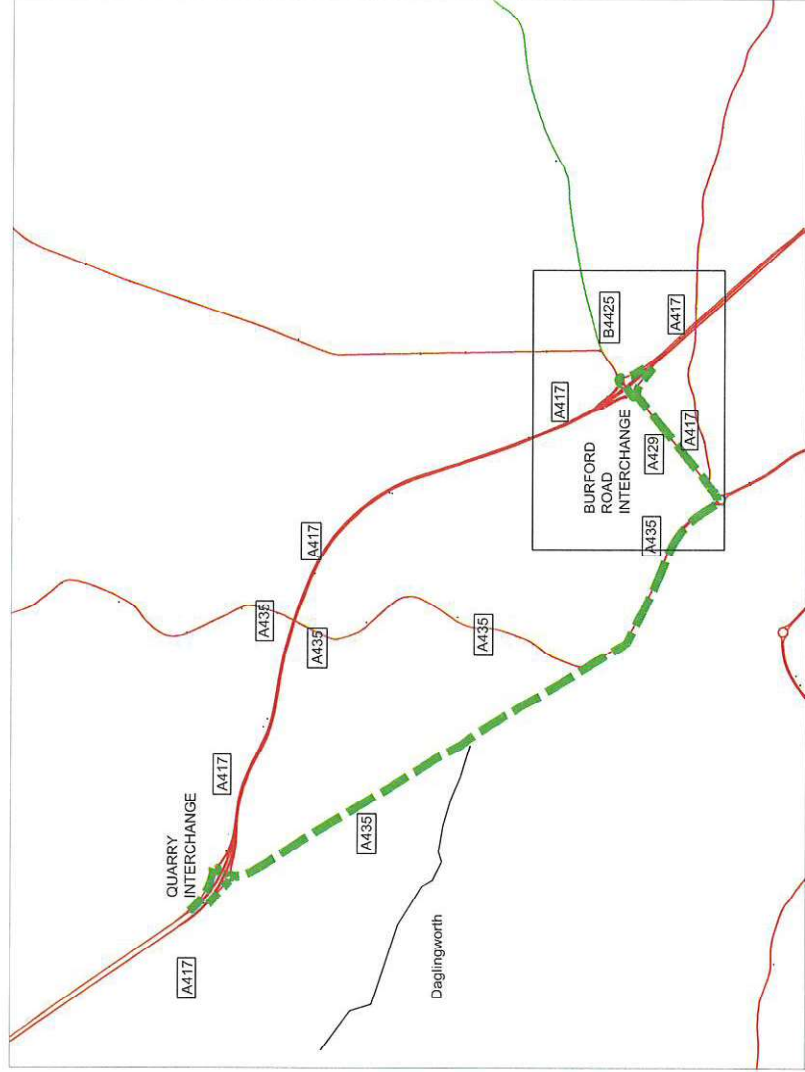

This route was agreed as the preferred option by the following parties during 2007:

Highways Agency, R.M.S. Gloucestershire Police and Gloucester County Council

HA HIGHWAYS
AGENCY

mouchel

Diversion Route 5 (Northbound)
Date

Sept 2008

ROUTE 5

**A417 Southbound Closed
Between
Quarry Interchange
And
Burford Road Interchange**



A417 SOUTHBOUND

CLOSED BETWEEN QUARRY INTERCHANGE AND BURFORD ROAD INTERCHANGE

Diversion Route
Symbol



Action Points

Step 1: Close A417 Southbound carriageway at Quarry Interchange.
Step 2: Open trigger signs at Quarry Interchange Exit Slip Reverse procedure at end of closure.

A417 Southbound Main Carriageway at Quarry Interchange Southbound Exit Slip Road.

Standard Road Closure to TMC requirements

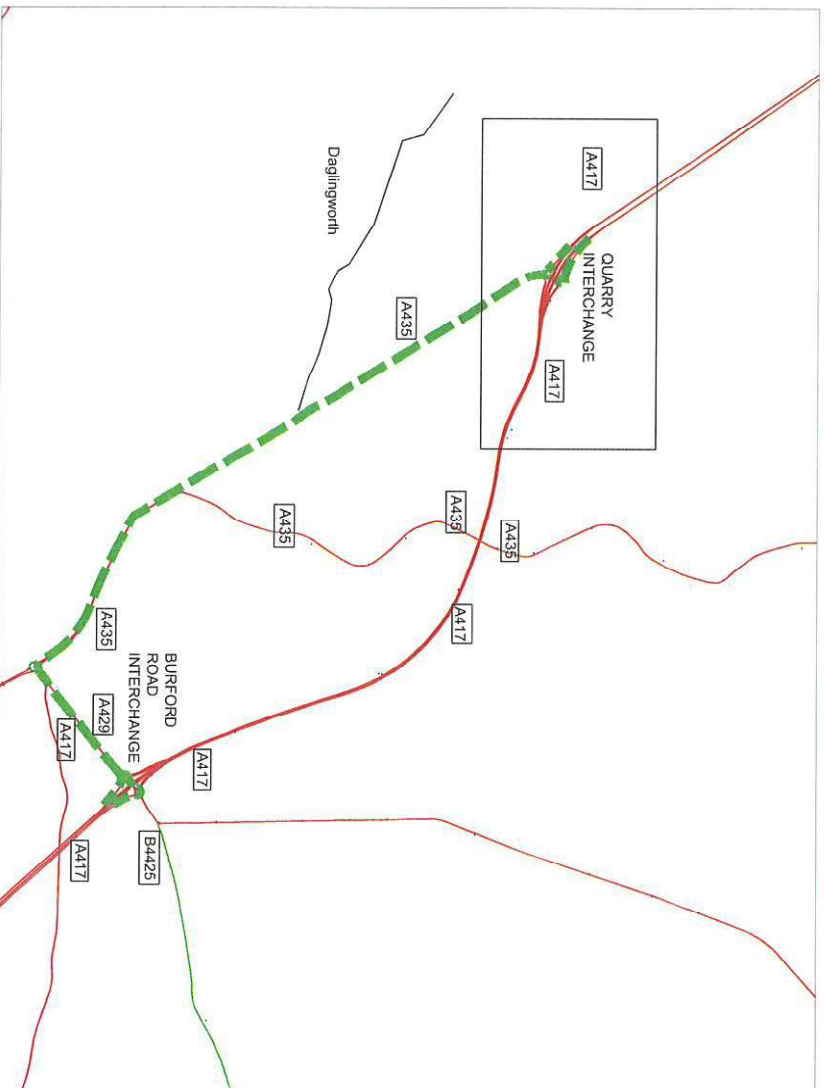

This route was agreed as the preferred option by the following parties during 2007:
Highways Agency, R.M.S. Gloucestershire Police and Gloucester County Council

HA HIGHWAYS
AGENCY

mouchel

Diversion Route 5 (Southbound)
A
Sept 2008

ROUTE 6

A417 Northbound Closed
Between
Spine Road Junction
And
Burford Road Interchange



CLOSED BETWEEN BURFORD ROAD INTERCHANGE AND SOUTH CERNEY JUNCTION

A419/A417 NORTHBOUND

Diversion Route
Symbol



Action Points

Step 1: Close A419/A417 Northbound carriageway at Cerney junction.
Step 2: Open trigger signs at South Cerney junction Exit Slip Road.
Reverse procedure at end of closure.

A417 Northbound Carriageway at South Cerney.
Northbound Exit Slip Road.

Standard Road Closure to TMC requirements

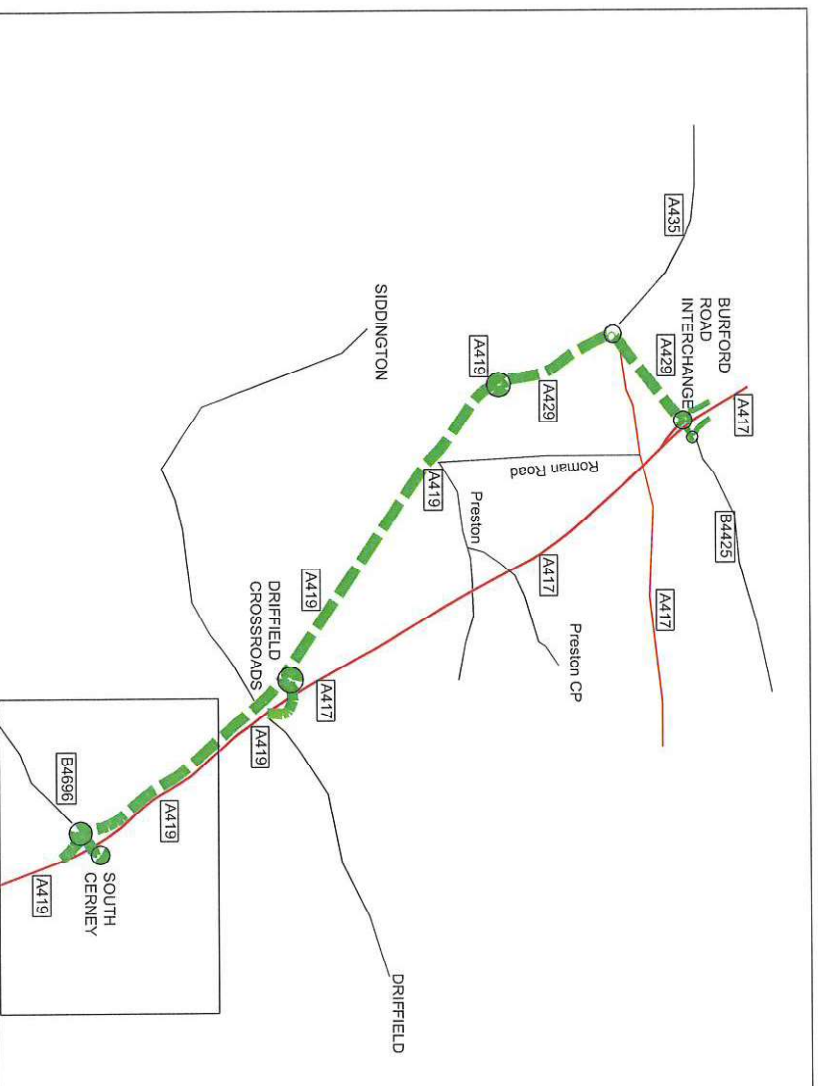

This route was agreed as the preferred option by the following parties during 2007:
Highways Agency, R.M.S., Gloucestershire Police and Gloucester County Council

HA HIGHWAYS
AGENCY

mouchel

Diversion Route 6 (Northbound)
Oct 2008

ROUTE 6

A417 Southbound Closed
Between
Burford Road Interchange
And
Spine Road Junction



CLOSED BETWEEN CIRENCESTER (BURFORD ROAD) AND SPINE ROAD JUNCTION.

Diversion Route
Symbol



Action Points

Step 1: Close A417/A419 Southbound carriageway at Burford Road Interchange.
Step 2: Open trigger signs at Burford Road Interchange Exit Slip Road.
Reverse procedure at end of closure.

A417 Southbound Main Carriageway at Burford Road Interchange Southbound Exit Slip Road.

Standard Road Closure to TMC requirements

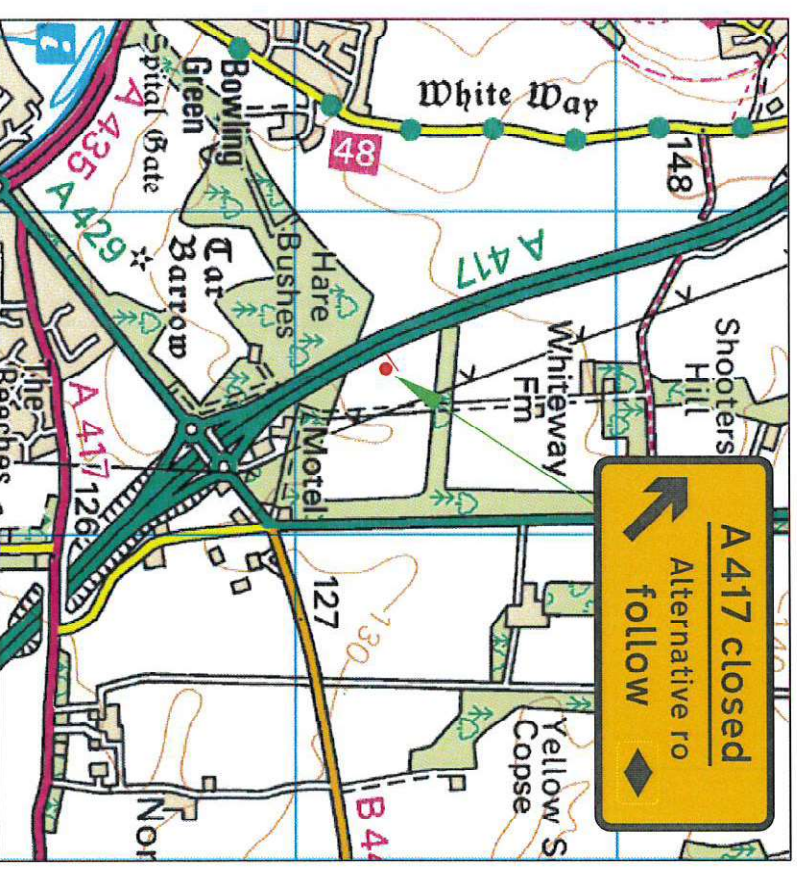
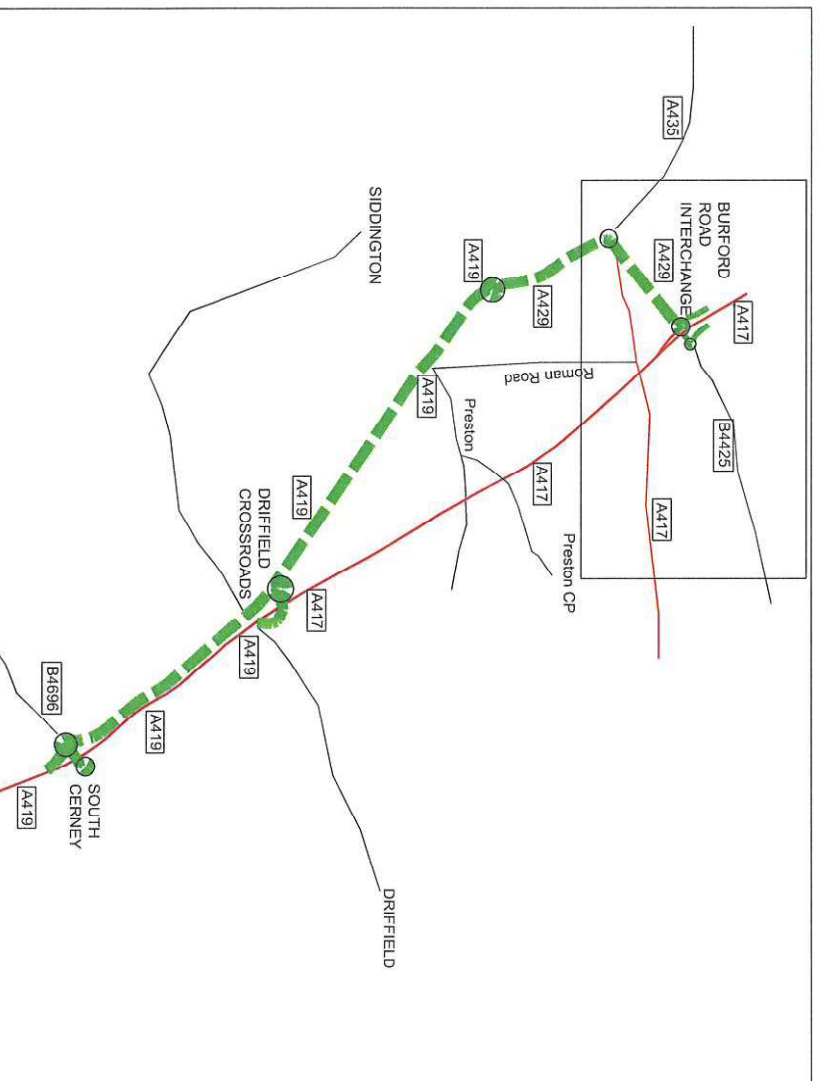

This route was agreed as the preferred option by the following parties during 2007:
Highways Agency, R.M.S. Gloucestershire Police and Gloucester County Council

HA HIGHWAYS
AGENCY

R mouchel

Diversion Route 6 (Southbound)
Oct. 2008

ROUTE 7

A419 Northbound Closed

Between

Cricklade Junction

And

Spine Road Junction



A419 NORTHBOUND CLOSED BETWEEN CRICKLADE JUNCTION AND SOUTH CERNEY JUNCTION

Diversion Route
Symbol

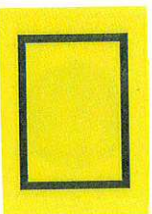

Action Points
 Step 1: Close A419 Northbound carriageway at Cricklade Junction with A4040
 Step 2: Open trigger signs at Cricklade Northbound Exit Slip Road.
 Reverse procedure at end of closure.

A419 Northbound Main Carriageway at Cricklade Northbound Exit Slip Road.

Standard Road Closure to TMC requirements

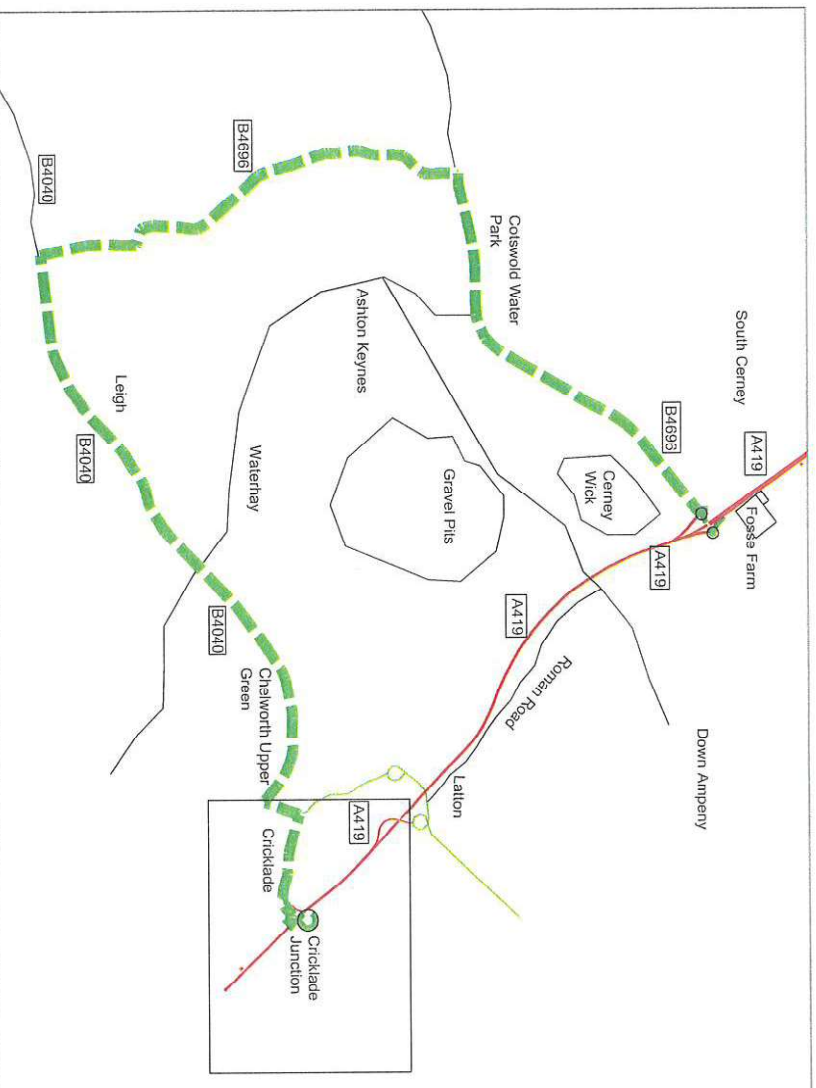

This route was agreed as the preferred option by the following parties during 2007:
 Highways Agency, R.M.S. Gloucestershire Police and Gloucester County Council

ROUTE 7

**A419 Southbound Closed
Between
Spine Road Junction
And
Cricklade Junction**



A419 SOUTHBOUND CLOSED BETWEEN SOUTH CERNEY JUNCTION AND CRICKLADE JUNCTION

Diversion Route
Symbol



Action Points
 Step 1: Close A419 Southbound carriageway at Cerney Junction with B4696.
 Step 2: Open trigger signs at South Cerney Southbound Exit Slip Road.
 Reverse procedure at end of closure.

A419 Southbound carriageway at Cerney Junction with B4696.
 Standard Road Closure to TMC requirements

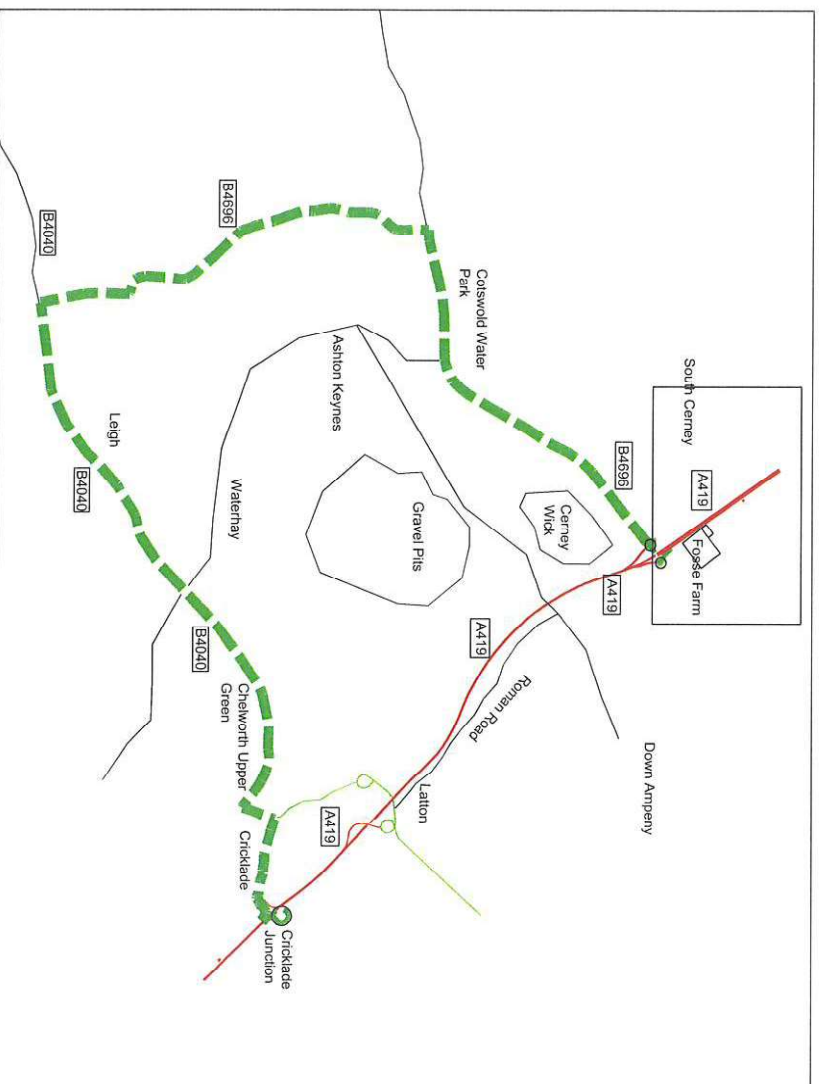

This route was agreed as the preferred option by the following parties during 2007:
 Highways Agency, R.M.S. Gloucestershire Police and Gloucester County Council

HA HIGHWAYS
 AGENCY

mouchel

Diversion Route 7 (Southbound)
 Oct 2008